

**NATIONAL MINE RESCUE CONTEST  
DAY 2 SUPERINTENDENT STATEMENT  
SEPTEMBER 11, 2013**

Thank you for coming to help us. You are located at the fresh air base at Crosscut 48 on the 001 section of the NMRC Big Blue mine. The section was rehabilitating old works to reach an isolated boundary of 8-foot coal.

This morning, the day shift crew went in about 4 am so they could get off early because of our company fishing tournament tomorrow. At 6 am, the foreman called out and said they were encountering methane and were going to try to ventilate it out. At 6:15 am, there was a loud noise, and a lot of air and dust came blowing out the drift mouth. We tried to contact the section, but got no response. The tracking system showed all seven of the miners to be on the section immediately before the blast. I contacted MSHA and state officials. I also contacted our sister companies' mine rescue teams. They have explored the mine up to the fresh air base and have explored and ventilated the entire mine behind you.

This mine has an exhaust fan that is currently off. It is being monitored and guarded. When in exhaust mode, air enters the section in the #1 entry and exits out the #3 entry. The fan can be stopped once it is started, and it can be reversed. To start or stop the fan, you must ask the superintendent to do so. All electrical power in by the portal has been de-energized, and the power is locked out and is being guarded.

This rehab area has a history of bad top and methane, and we have had some water problems in this mine. The seam height here is about 7-foot. The mine maps are up to date. We have a competent life line person to give and take life line signals if necessary. There are back up and standby teams ready to assist you.

Once your team goes in by, the Briefing Officer will be stationed in an airtight isolation area and you only will be able to contact him through your communication system.

If any face-down placards are encountered, the captain must turn them over before passing them.

Please find the missing miners. Thank you and good luck.

# National Mine Rescue Contest

## Day #2 Problem

Scale: 1 inch = 20 feet

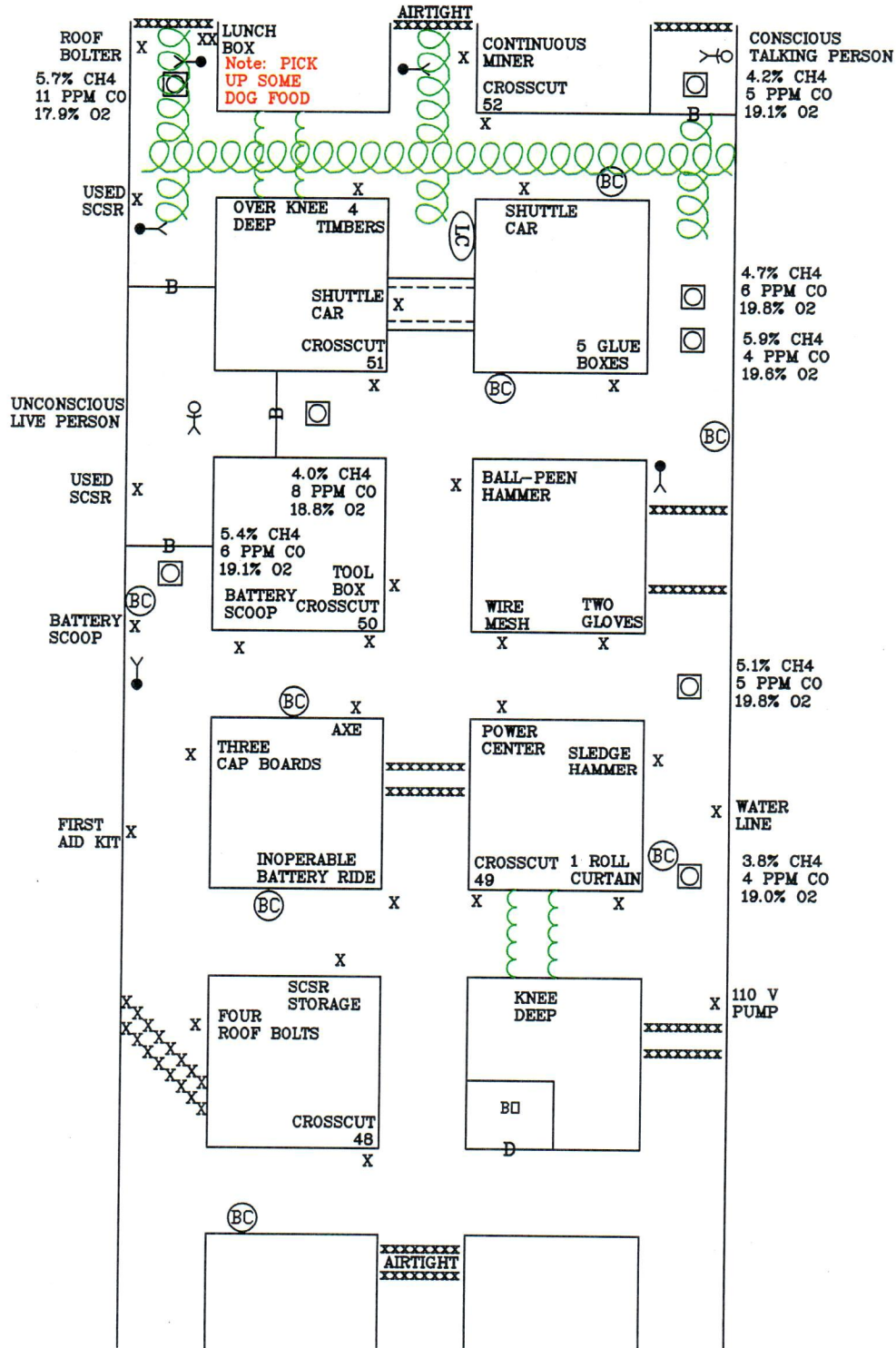

# PROBLEM

ACCOUNT FOR ALL MISSING MINERS  
AND BRING SURVIVORS TO THE  
SURFACE

EXPLORE ALL AREAS OF THE MINE THAT  
CAN BE DONE SO SAFELY

TEAM CAN ONLY CARRY TWO SETS OF  
BRATTICE CLOTH WHILE ADVANCING  
OR RETREATING

BRIEFING OFFICER MUST REQUEST  
PERMISSION IN WRITING FROM THE  
SUPERINTENDENT TO START OR STOP  
THE FAN. FAN MUST BE STOPPED BEFORE  
CHANGING AIR DIRECTION. BRIEFING  
OFFICER MUST CIRCLE AIR DIRECTION

YOU CAN START AND STOP THE FAN A  
MAXIMUM OF THREE TIMES EACH  
BEFORE IT OVERHEATS

YOU HAVE 60 MINUTES TO WORK BEFORE  
BEING REPLACED BY ANOTHER TEAM



**RADIO/PHONE  
BARRICADE  
STATEMENT**

**HELP! I AM BEHIND A  
BARRICADE IN THE #3 ENTRY  
INBY CROSSCUT 52! PLEASE  
GET ME OUT OF HERE!**

**BARRICADE  
STATEMENT**

**HELP!  
PLEASE GET ME OUT OF  
HERE!**



# National Mine Rescue Contest Day #2 Problem (Extent of Gases)

Scale: 1 inch = 20 feet

- Explosive & Irrespirable
- Explosive
- Irrespirable

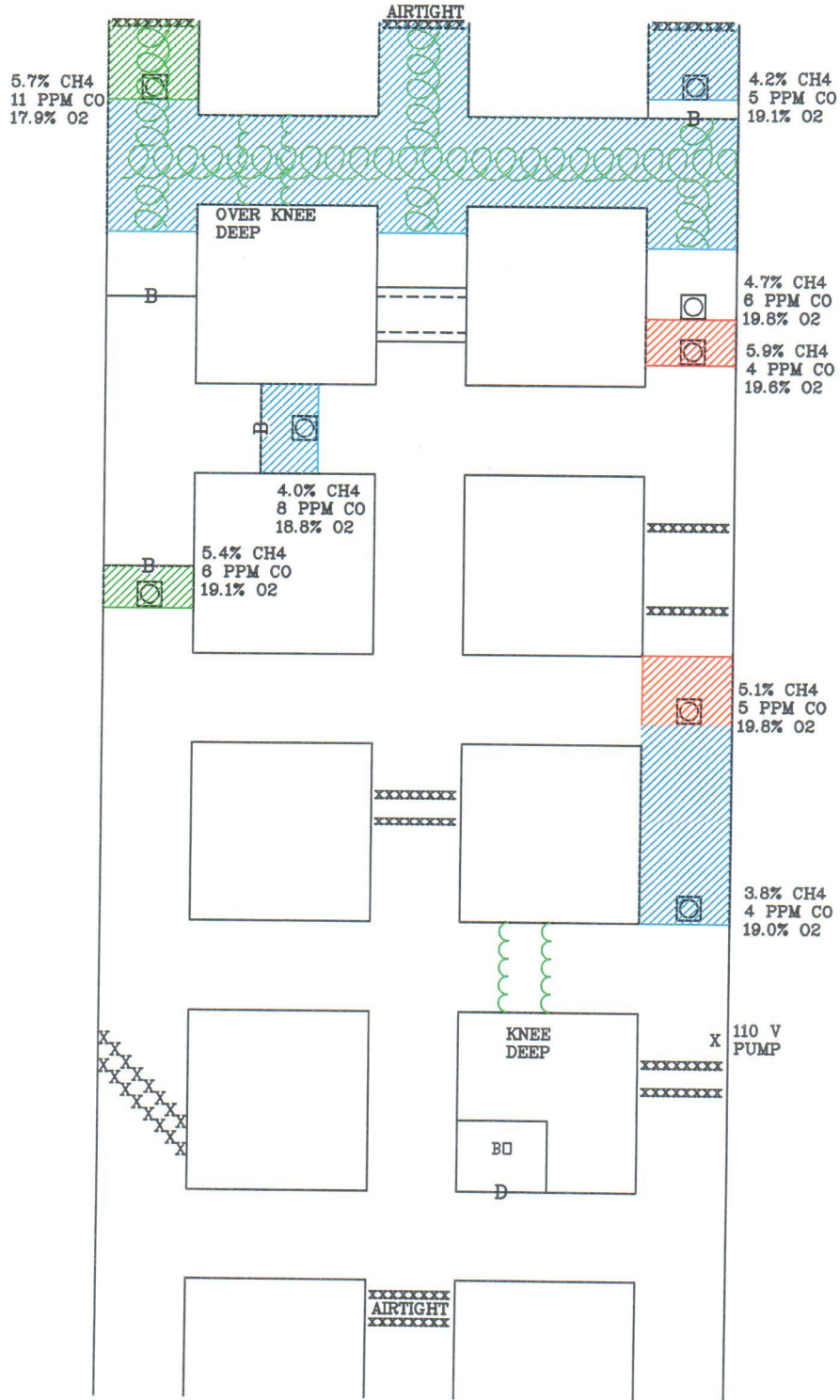

# VENTILATION # 1

Scale: 1 inch = 20 feet

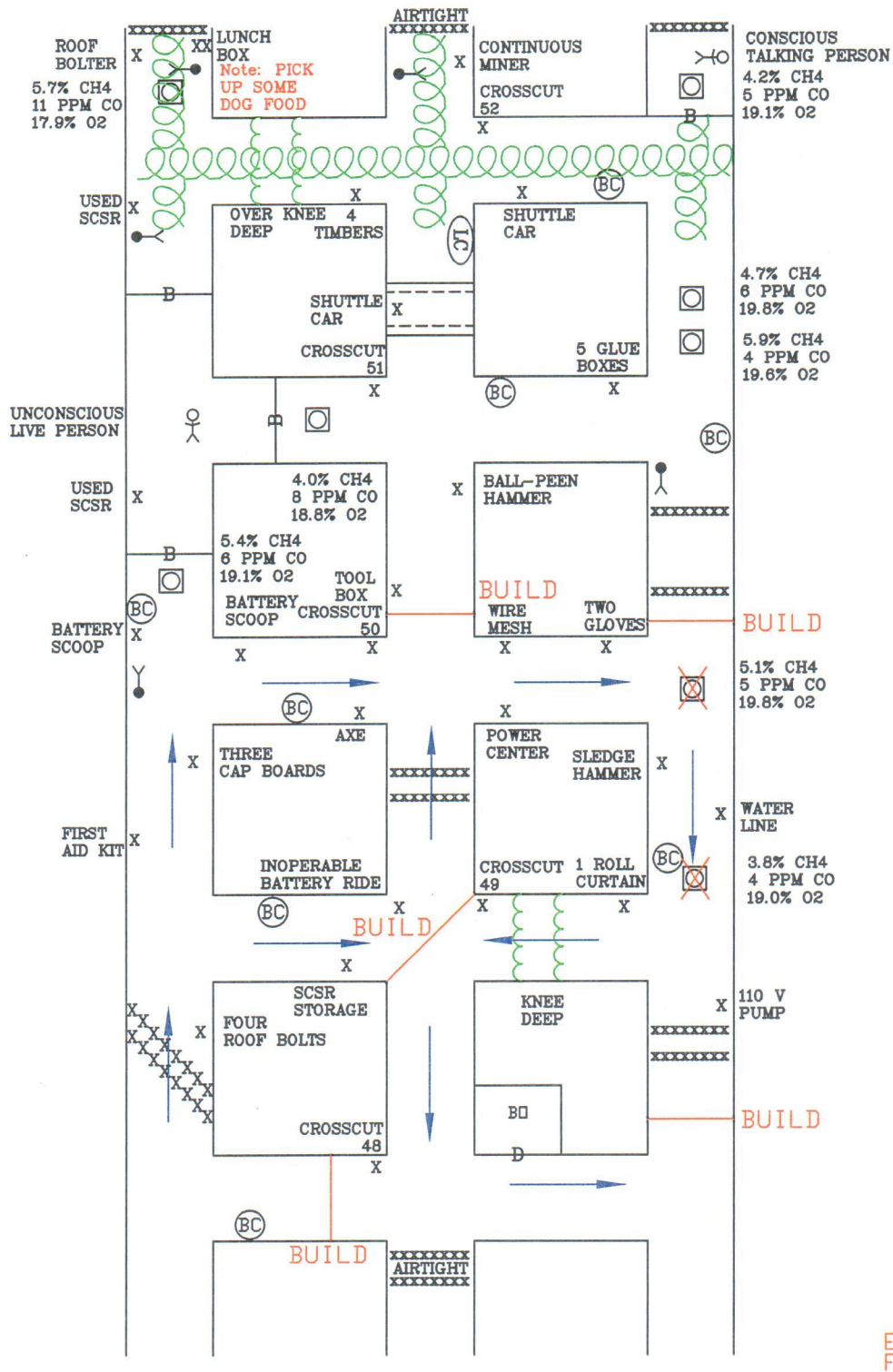



# VENTILATION # 3

Scale: 1 inch = 20 feet

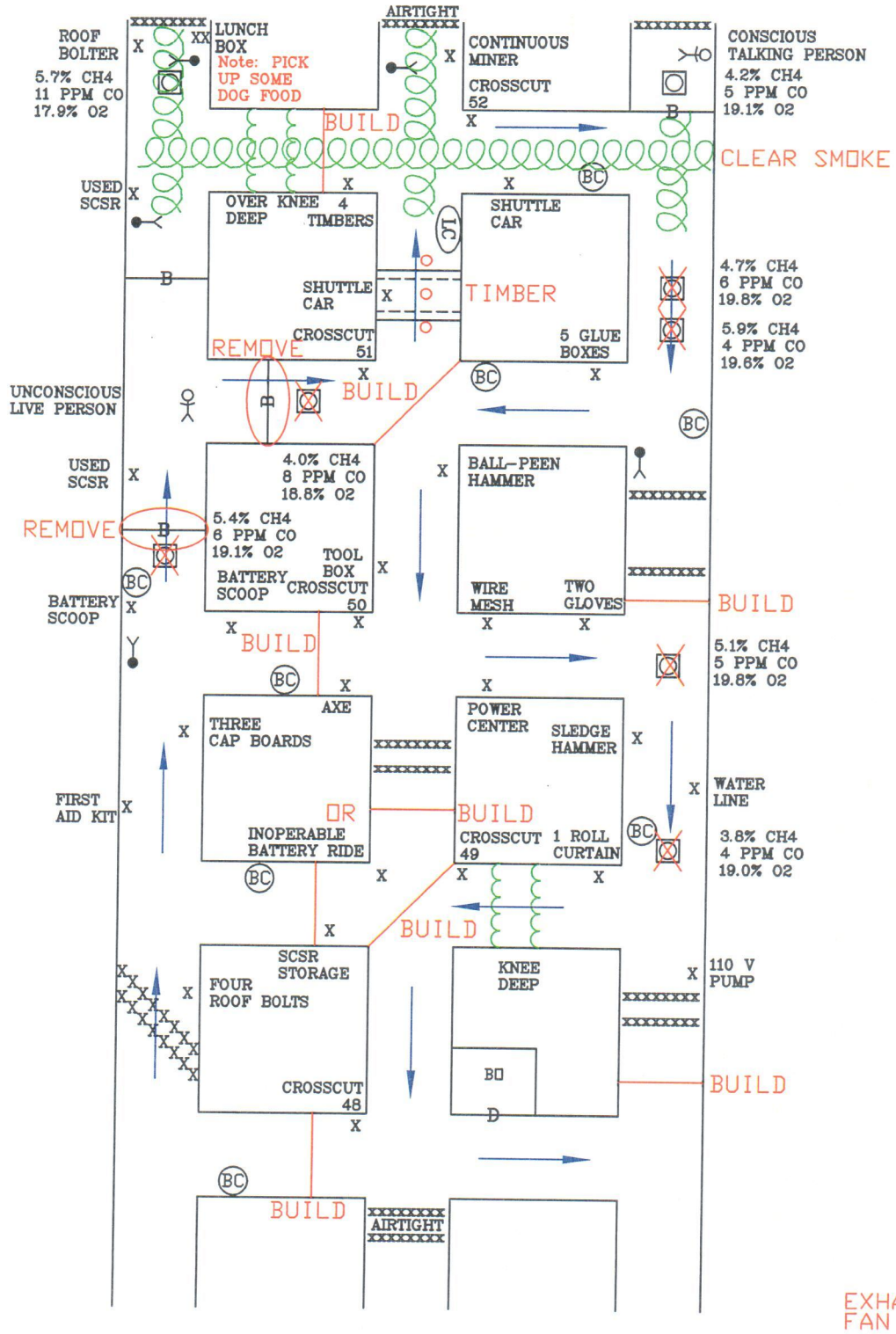

# Final Ventilation

Scale: 1 inch = 20 feet

