

2014 MTTC Pennsylvania Regional Skills Contest



April 22-25, 2014

Problem Statement

You are located at the Fresh Air Base of the D K Mine. This is a 3 entry section that is developing the headgate entries for a longwall Panel.

A fireboss called out and said he was getting accumulations of methane and needed help. The shift foreman sent a 3 man crew up to the section to assist him so he can leave and continue his run. The tracking system stopped working shortly after the 3 man crew arrived and there has been no communication with anyone since. The number 3 entry has been cribbed due to sagging roof conditions and has not been cut down yet but is safe to enter.

There is a trained mine rescue team here to back you up and the power has been locked out and guarded. The maps you will receive when you start the clock will be up to date.

Please be careful and find our miners.

2014 MTTC PA SKILLS

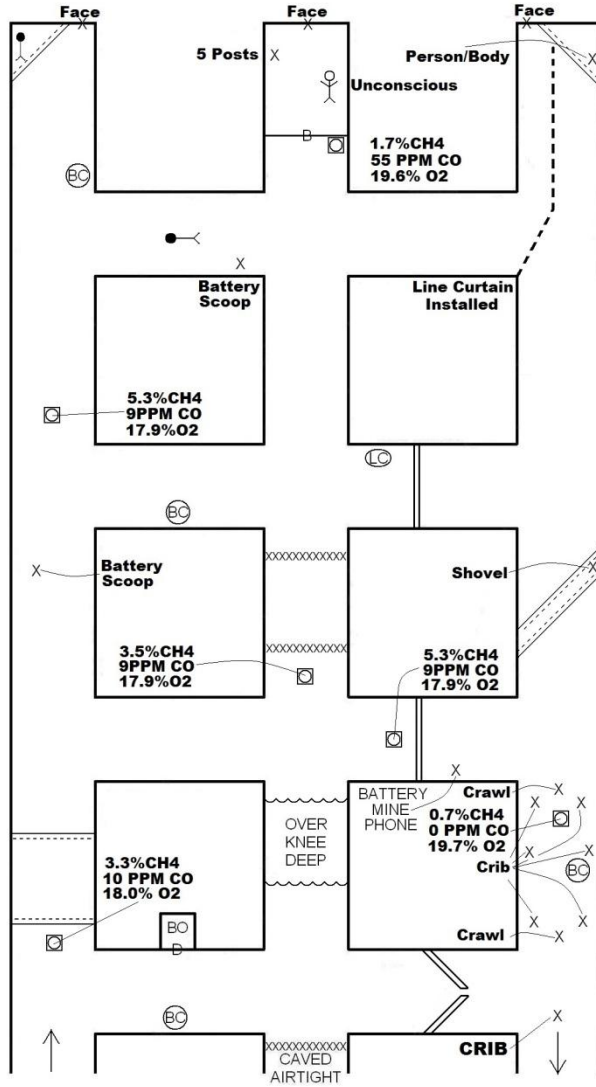

2014 MTTC PA Regional Skills
Contest

Written Instructions

**ACCOUNT FOR ALL THE MISSING
MINERS AND BRING LIVE PERSONS
TO THE FRESH AIR BASE**

**THE EXHAUST FAN IS RUNNING AND
CANNOT BE REVERSED**

**THE BRIEFING OFFICER HAS BEEN
ISOLATED AND MUST REMAIN IN A
RESPIRABLE ATMOSPHERE**



TEAM MAP

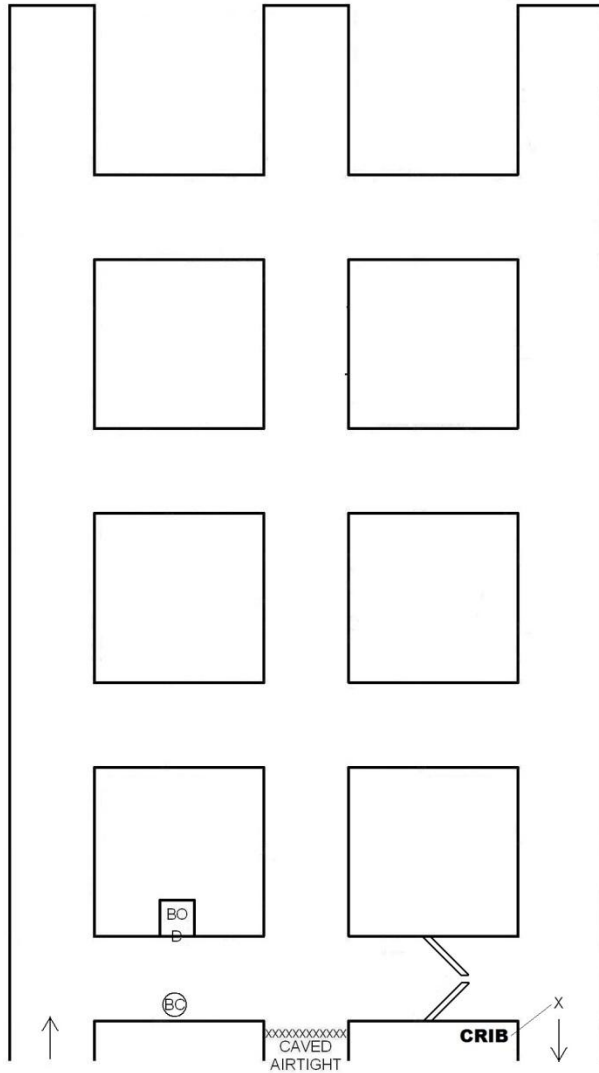

BO MAP

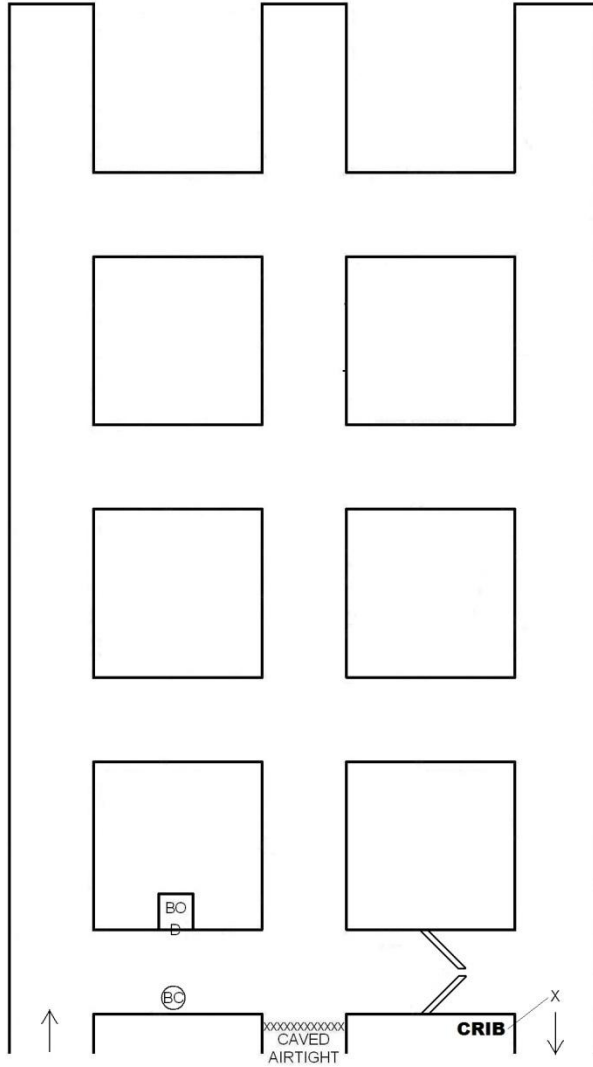

Possible Team Stops

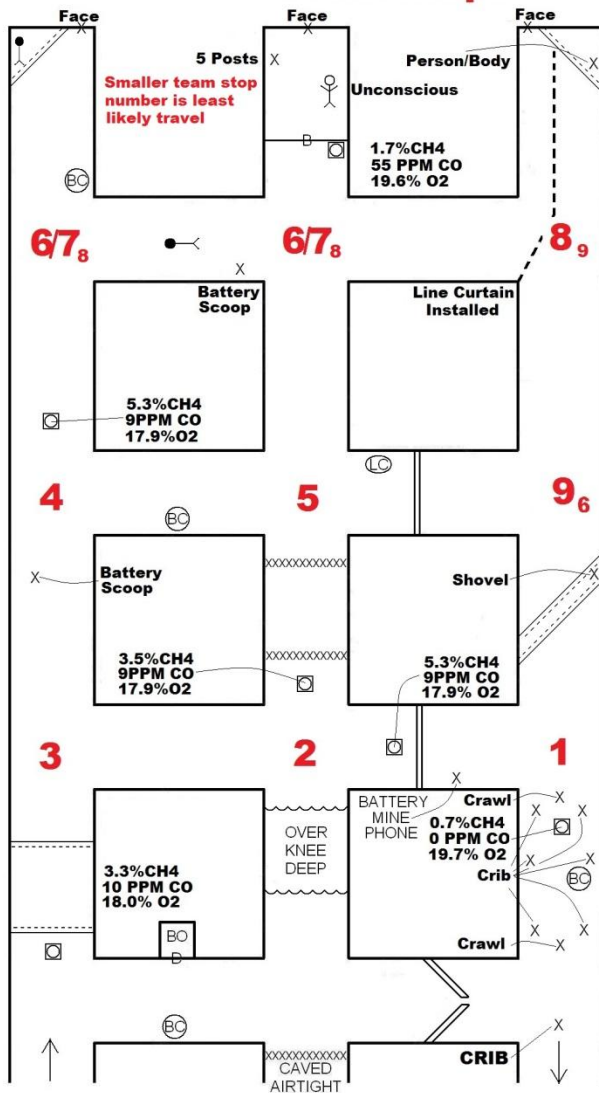

DATE/INITIAL GAS TESTS ROOF/RIB

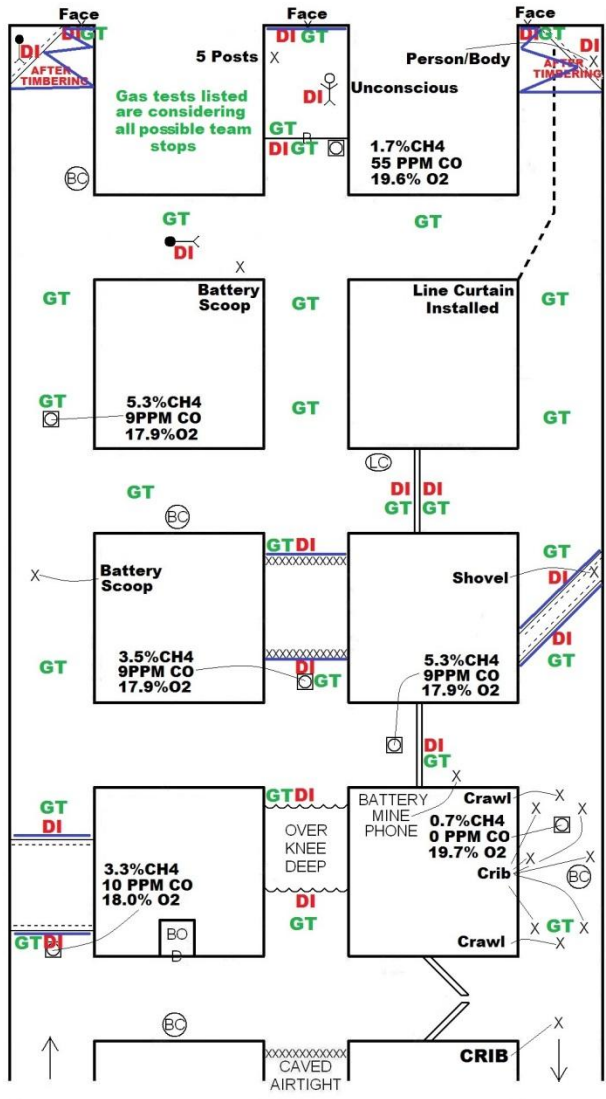

EXPLOSIVE IRRESPIRABLE

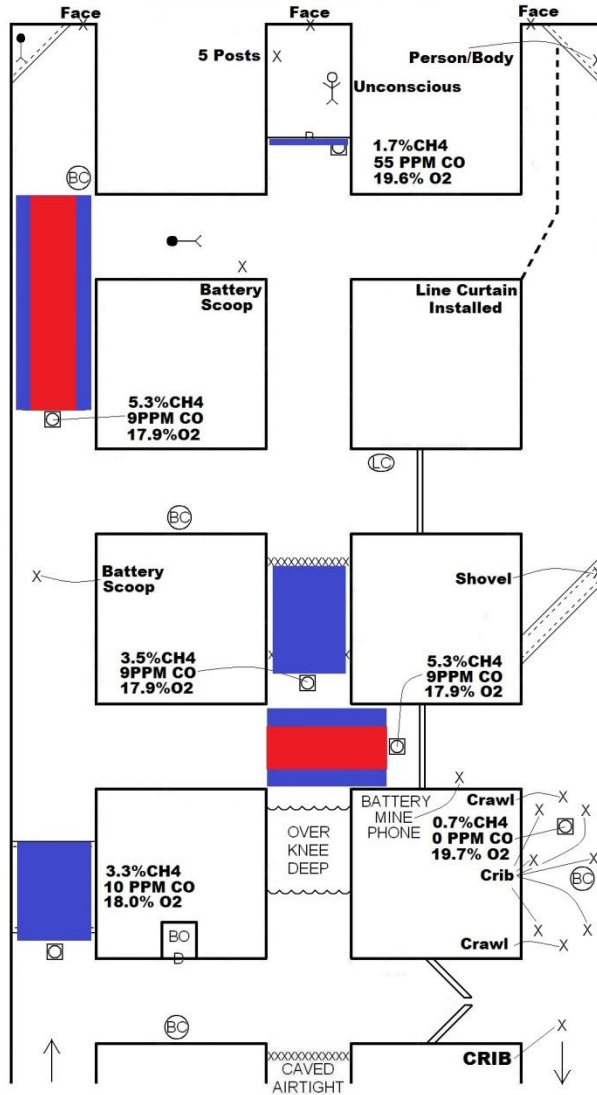

FIRST VENT

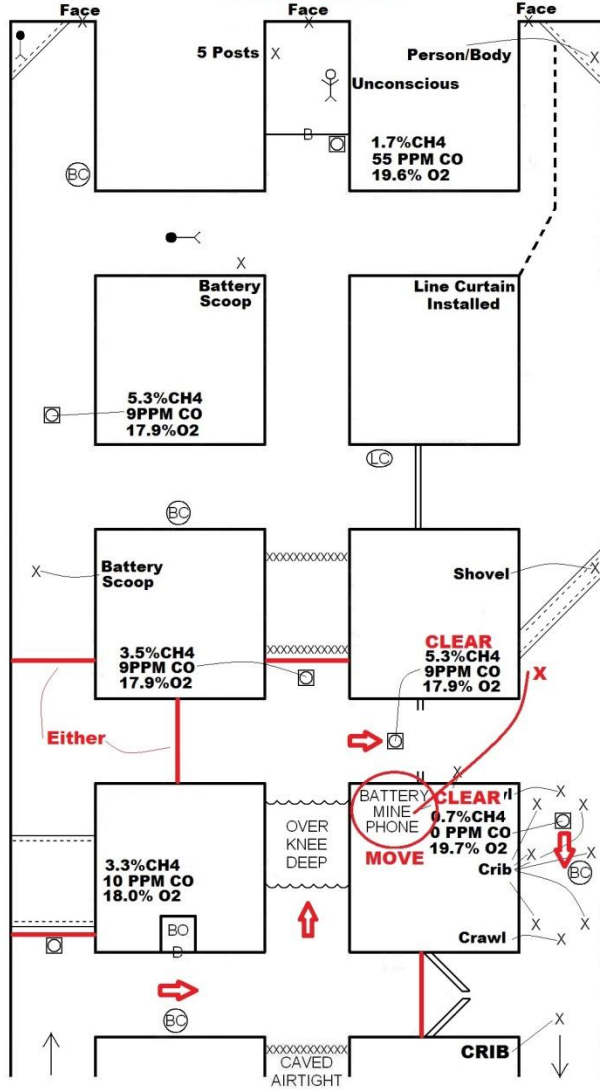

2ND VENT

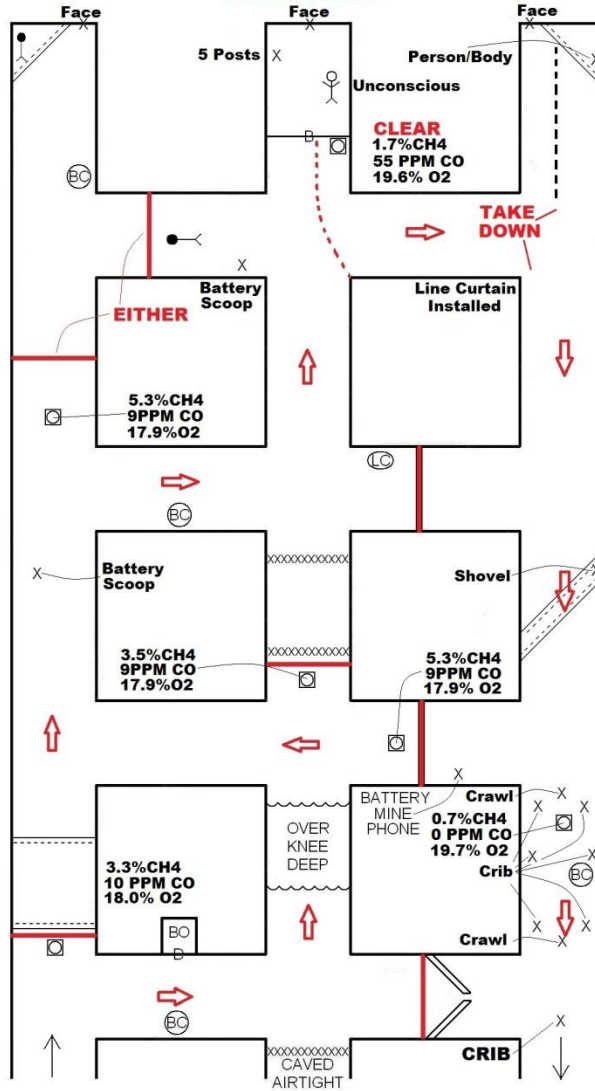

Keys to Problem

- **Team must enter the mine in the # 3 entry**
- **Team will airlock through the permanent stopping 3 to 2 and tie across to # 1 entry**
- **When team gets to team stop # 5 they will have the option to drive # 1 or # 2 entry**
- **If team travels # 2 entry to C crosscut, team must go to # 1 entry before going to # 3 entry**
- **Team will have to flush the explosive mixture out of A crosscut before venting the barricade**
- **Before the team vents the barricade in # 2 entry, team must take down the installed line curtain in # 3 entry**
- **Team must post into the person in # 3 entry which becomes a body. With the posts that are left, the team then must post into the body in # 1 entry**