

Aug 1st 2014

Mine Rescue Practice Problem



Ole Smokey # 9 mine

Problem Statement

You are located at the Fresh Air Base of “Ole Smokey” no.9 mine. This is a 3 entry section that is developing the headgate entries for a longwall Panel.

About 3 hours ago, the foreman called outside and told the dispatcher that the continuous miner was on fire and that he and his crew was using all means available to extinguish the fire and that he would call every few minutes to give an update.

A contract mine rescue team was called after several minutes had passed and no communication from the foreman had occurred.

The contract team encountered heavy smoke in all entries during their exploration and had to come outside after a team member became ill.

The team was able to set up a fresh air base about 4 or 5 crosscuts outby the faces. Please continue your search for our 11 missing miners.

There is a trained mine rescue team here to back you up and the power has been locked out and guarded. The maps you will receive when you start the clock will not be up to date.

Please be careful and find our miners.

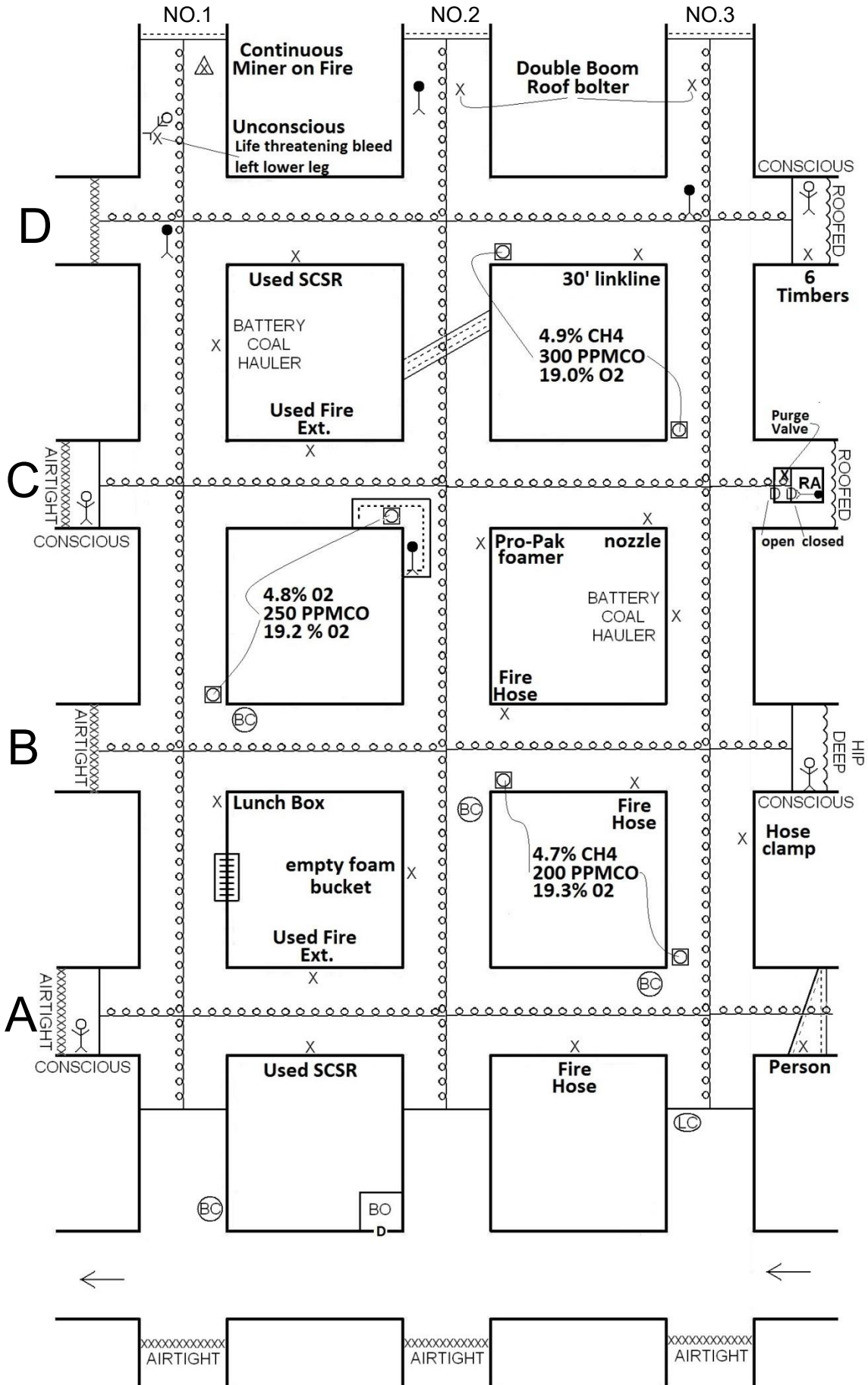

2014 Aug.1st Practice

Written Instructions

- **ACCOUNT FOR ALL THE MISSING MINERS AND BRING LIVE PERSONS TO THE FRESH AIR BASE**
- **THE EXHAUST FAN IS RUNNING AND CANNOT BE REVERSED OR STALLED**
- **ANY PATIENT LOADED ONTO A STRETCHER MUST BE CARRIED TO THE FRESH AIR BASE, NOT ROLLED ON THE STRETCHER'S WHEELS TO GET TO THE FAB**
- **TEAM MUST TRAVEL NO.1 ENTRY WHEN GOING INBY THE FAB DURING INITIAL EXPLORATION**
- **TEAM MUST TRAVEL NO. 3 ENTRY WHEN GOING INBY "A" CROSSCUT DURING INITIAL EXPLORATION**
- **TEAM MUST TRAVEL NO.1 ENTRY WHEN GOING INBY "B" CROSSCUT DURING INITIAL EXPLORATION**
- **TEAM MUST TRAVEL NO.3 ENTRY WHEN GOING INBY "C" CROSSCUT DURING INITIAL EXPLORATION**
- **THE BRIEFING OFFICER HAS BEEN ISOLATED AND MUST REMAIN IN A RESPIRABLE ATMOSPHERE**

Statement for all
Conscious patients
behind stoppings

**Help! Get me
out of here !**

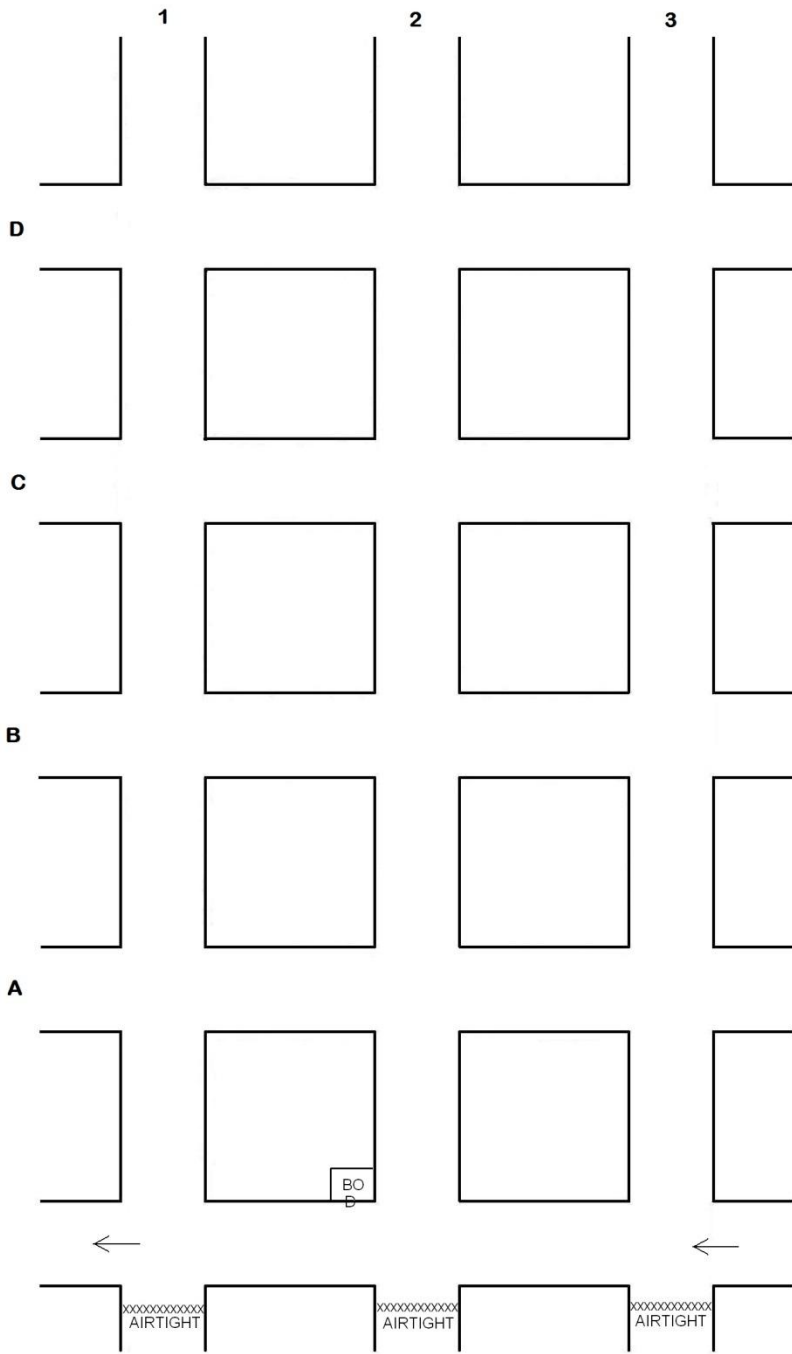

TEAM STOPS

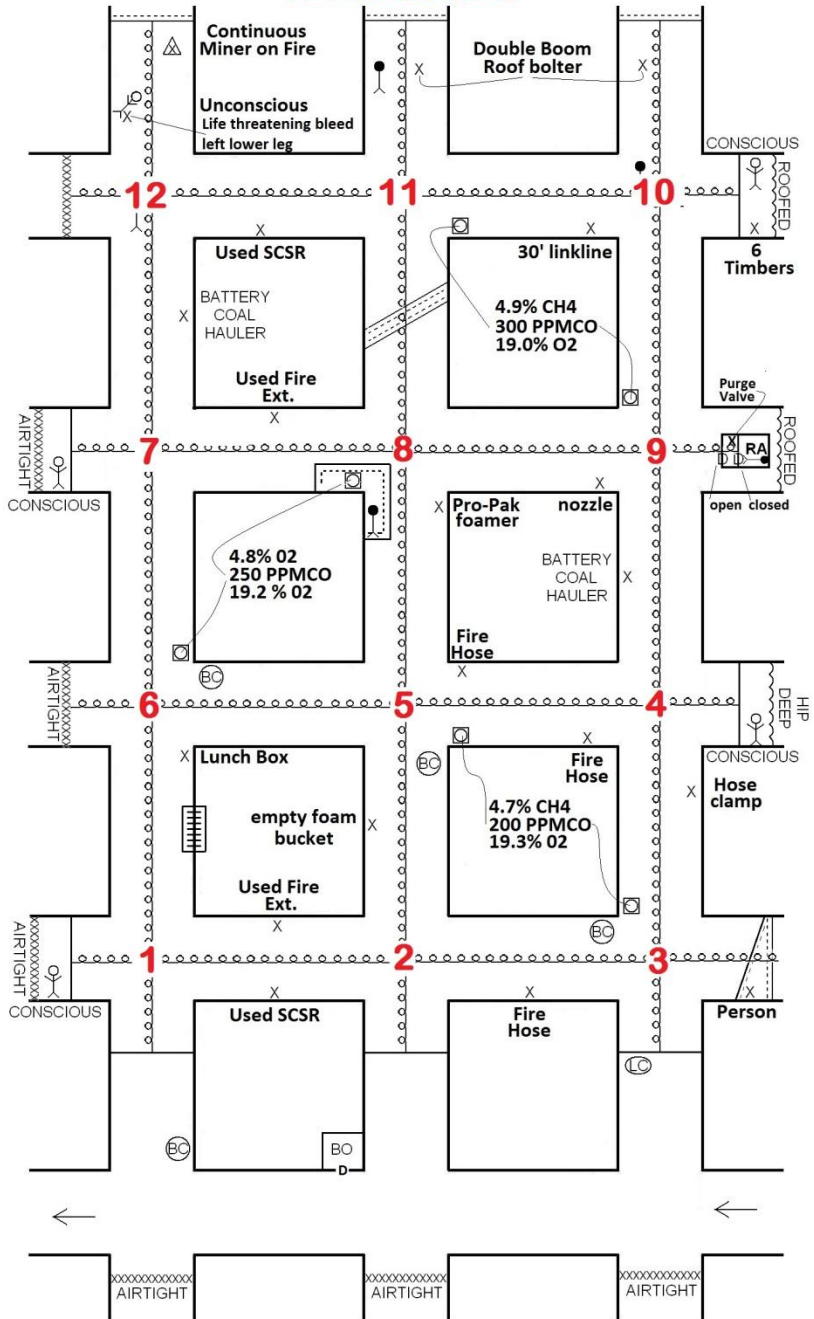

Gas Test Date & Int. Roof & Rib

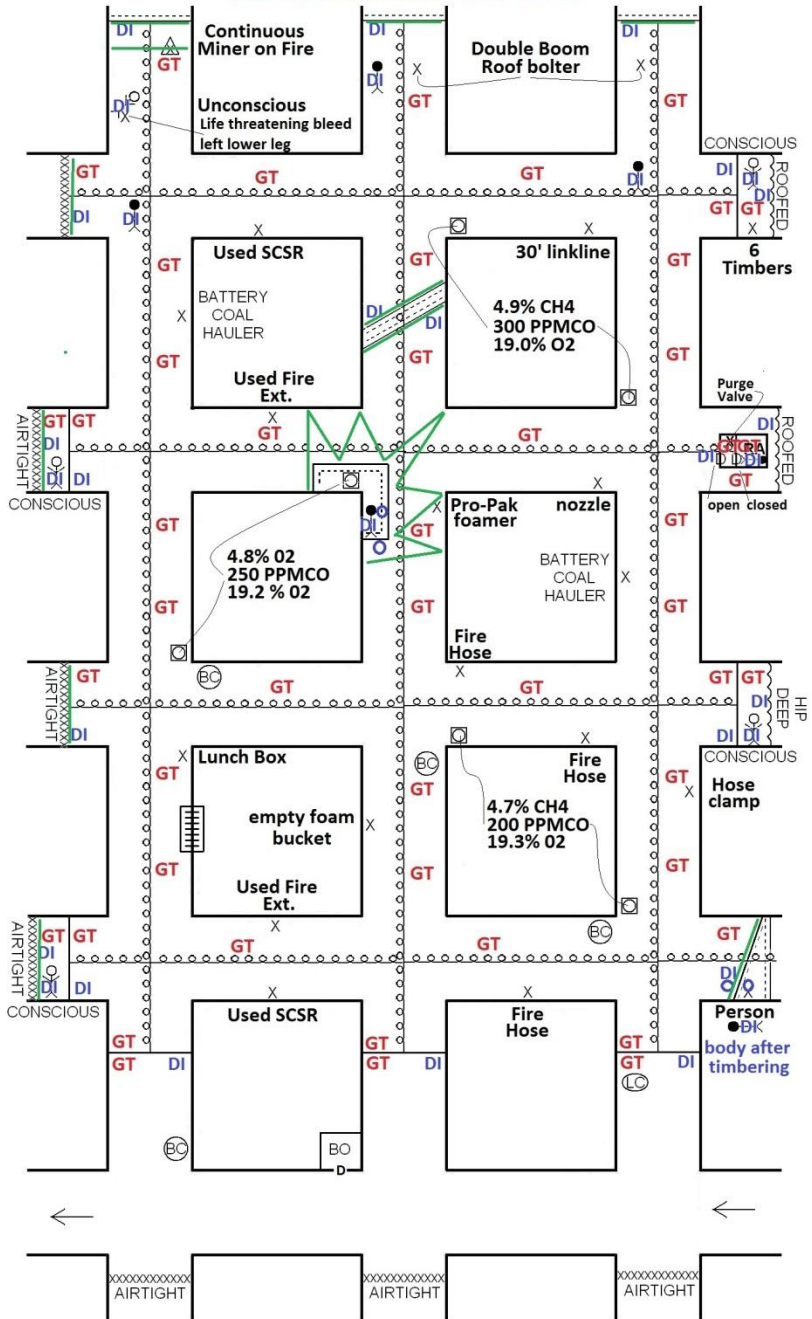

FIRST VENT

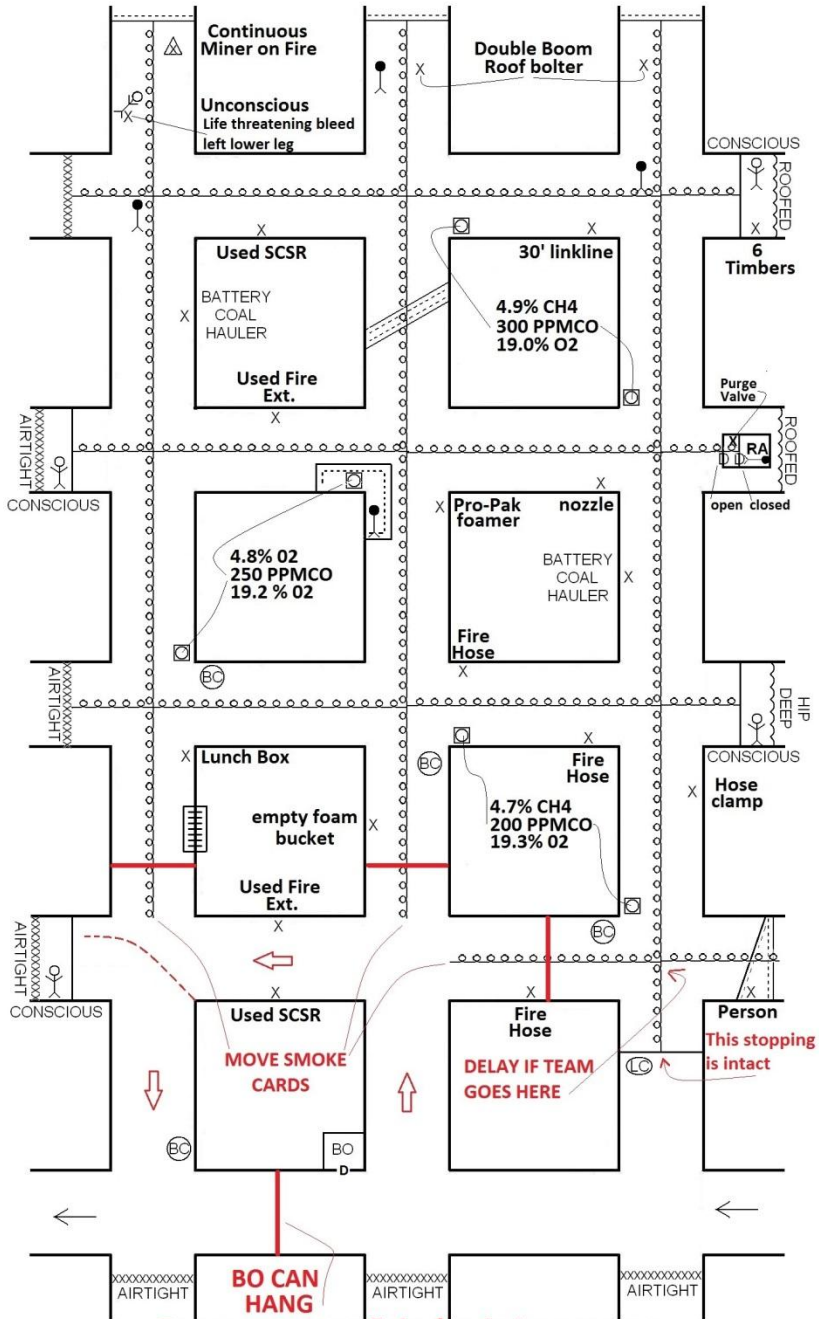

BO CAN HANG
Team must not stall the fan during any vent

2ND VENT

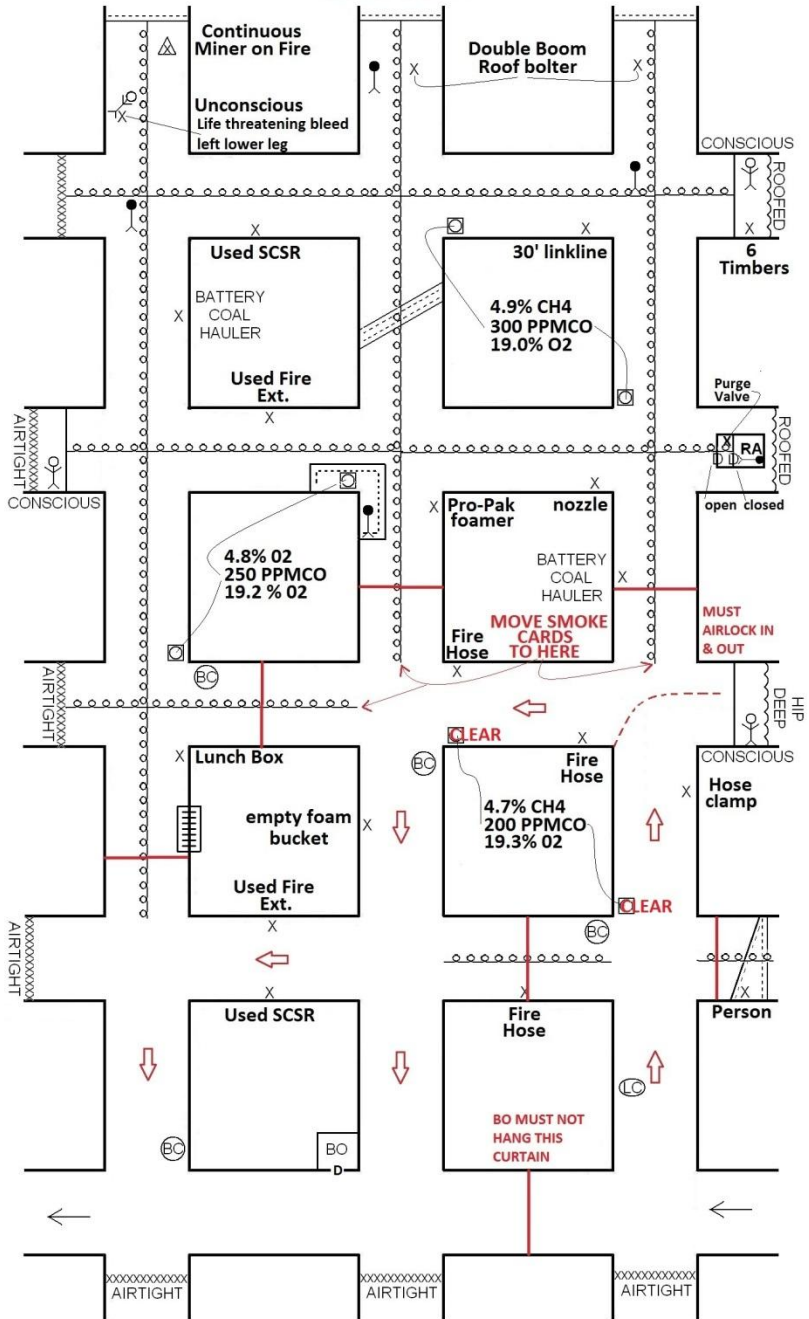

3RD VENT

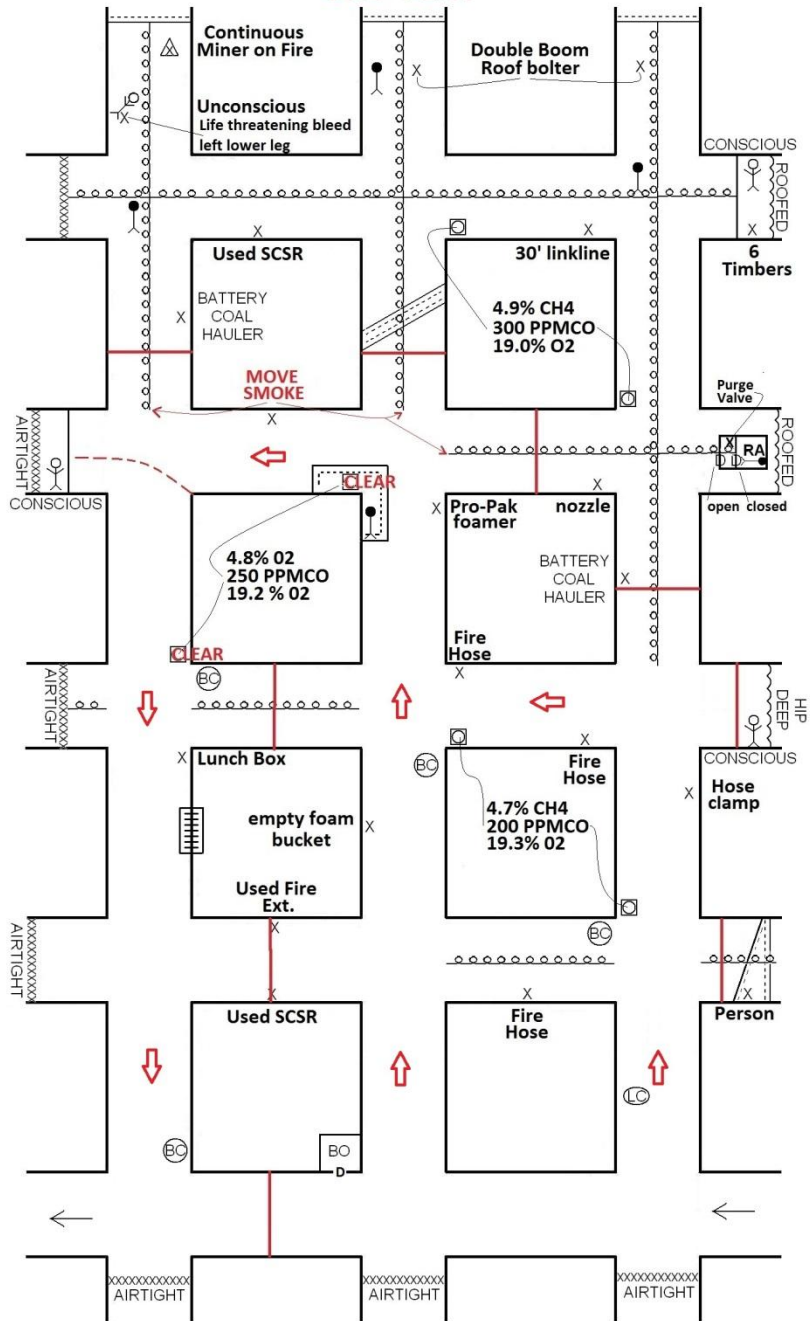

4TH VENT

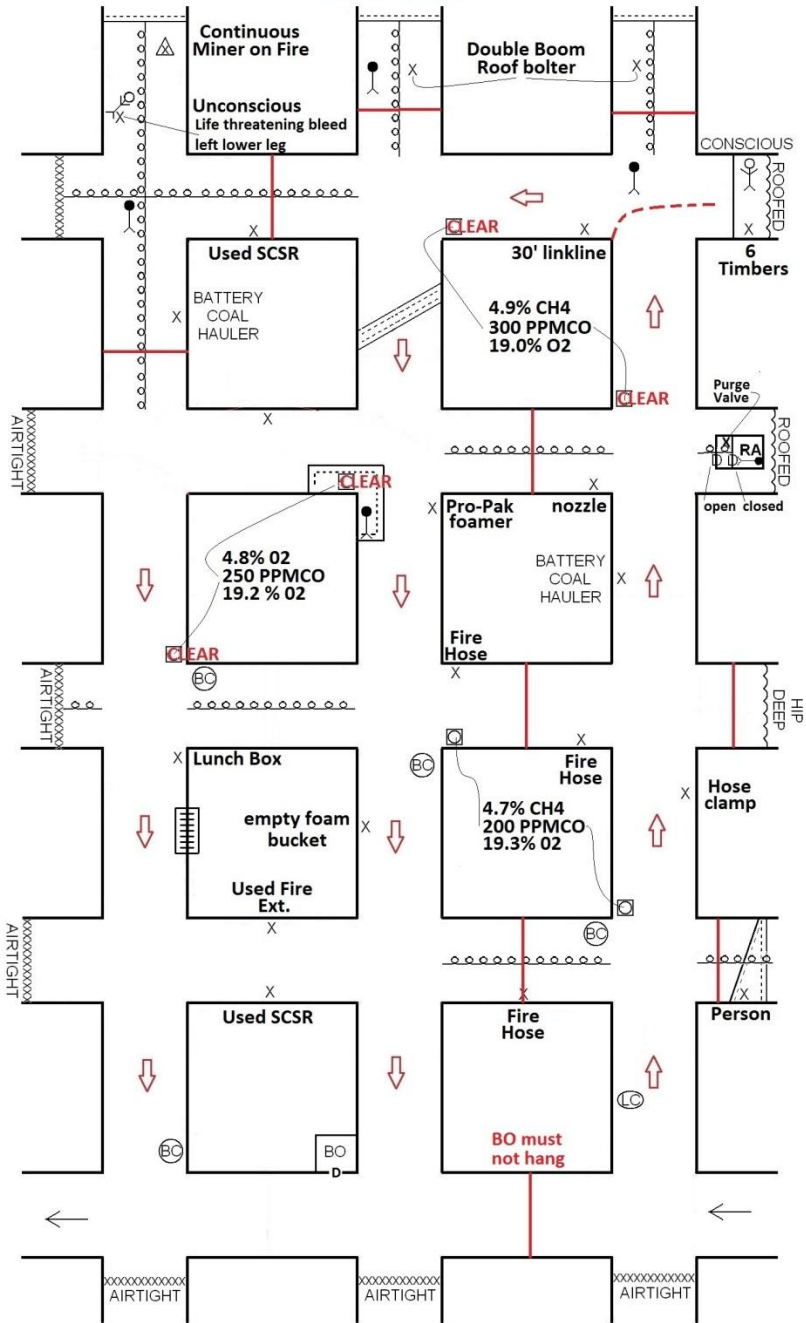

Keys to Problem

- Team must enter the mine in the # 1 entry
- Team must follow written instructions on team travel during exploration ...Gas placards are for mapping purposes ...Smoke is everywhere
- Team must not delay at each crosscut when tied to patient in that line of crosscuts
- Team must have all openings block in by FAB when airlocks are down for ventilation
- Team must purge smoke from RA before entering inner door
- Team must timber to person in unsafe roof after finding timbers in behind Temp stopping
- Team must timber to body in unsafe roof before stopping the clock