

240R

VISUAL

Hole in Diaphragm

Spring off Mask Yellow Button ID Only

Missing O-ring from Constant Flow Line ID ONLY

Mask Allan Screw Loose ID ONLY

Hole in Vent Valve Seat

TESTER

Missing Large O-ring

~~Demand Valve Fitting Loose~~ DELETED

~~O2 Regulator Feed Line Loose 7/16 Fitting~~ DELETED

Flow Restrictor Loose

2402

VISUAL APPARATUS CHECKS		TEST APPARATUS		
<input checked="" type="checkbox"/>	Check if ok	CONNECTIONS		
	UPPER HOUSING	Vent Valve Assembly - Hand Tight		
	LOWER HOUSING	Diaphragm Worm Gear - Wrench Tight		
	Harness Assembly	Flow Restrictor - Wrench Tight		
	External Gage	Breathing Hose Worm Gear - Wrench Tight		
	O2 Regulator /Outlet Tube O-ring	Add / Constant Fittings - Hand Tight		
	RMS	Center Section Lid - Hand Tight		
	CENTER SECTION ASSEMBLY	Center Section Push Pins - Hand Tight		
	Diaphragm	Cylinder Connection - Hand Tight		
	Check O-Ring for damages/lubrication	Adapter to Facepiece - Hand Tight		
	Sealing Edges	Test Fixture Connections - Hand Tight		
	Demand Valve Assembly	<input checked="" type="checkbox"/>	Check if ok	
	Moisture Pads	Zero Adjust the Mag. Gauge		
	PCM	CONSTANT FLOW TEST		
	CARBON DIOXIDE SCRUBBER	Flow Between 1.6 and 2.4 Lpm - State Reading		
	Defects / Damage	DEMAND VALVE TEST		
	Gasket	EMERGENCY BYPASS TEST		
	Expiration Date	VENT VALVE TEST		
	CENTER SECTION LID ASSEMBLY	At or below 2 inches wg - State Reading		
	Examine for defects / damage	LOW PRESSURE LEAK TEST		
	Sealing Edges	RMS GAUGE AND TRIM TEST		
	Ice Canisters	Observe lights/gauges +/- 10% - State Reading		
	Coolant Lids	HIGH PRESSURE LEAK TEST		
	CYLINDER TEST	LOW PRESSURE ALARM TEST		
	Hydrostatic Test Date	Alarm 650-1000 psig - State Reading		
	Cylinder Pressure on Gauge	Power down below 25 psig		
	Pressure Rating on Cylinder	VI	C	VISUAL
	HOSES			Hole in Diaphragm
	Sealing Edges		X	Spring off Mask Yellow Button ID Only
	Stretching of Hoses for Pliability		X	Missing O-ring from Constant Flow Line
	Adapter Assy O-ring damage & lubrication		X	Mask Allan Screw Loose
	FACE PIECE TEST			Hole in Vent Valve Seat
	Head Strap Assembly			
	Mask Body / Nose Cup	VI	C	TESTER
	Sealing Edges			Missing Large O-ring
	Speech Diaphragms			Demand Valve Fitting Loose
	Lens / Anti-Fog Insert			O2 Regulator Feed Line Loose 7/16 Fitting
	Magnetic Wiper			Flow Restrictor Loose

X = Correct only

29. Item # 3 of the Center Section Lid Assembly

scrubber holder

scrubber brace

flow baffle

30. Item #4 of the Center Section Lid Assembly

Metal screw

self-tapping screws

stainless screw

Center Section Lid Assembly

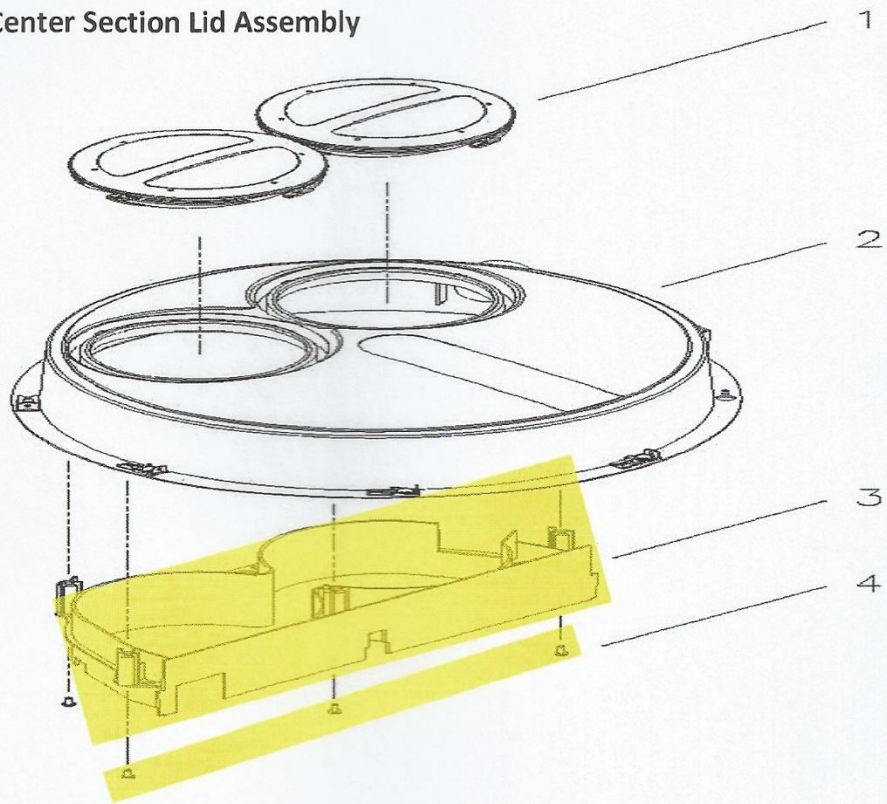

25. Item # 1 of the Pneumatic Assembly
 supply line oxygen supply line bypass feed tube
26. Item # 2 of the Pneumatic Assembly
 bypass line bypass return tube supply line
27. Item # 6 of the Pneumatic Assembly
 bypass valve button bypass valve push button bypass valve
28. Item # 9 of the Pneumatic Assembly
 Oxygen regulator assembly regulator assembly regulator

Pneumatic Assembly

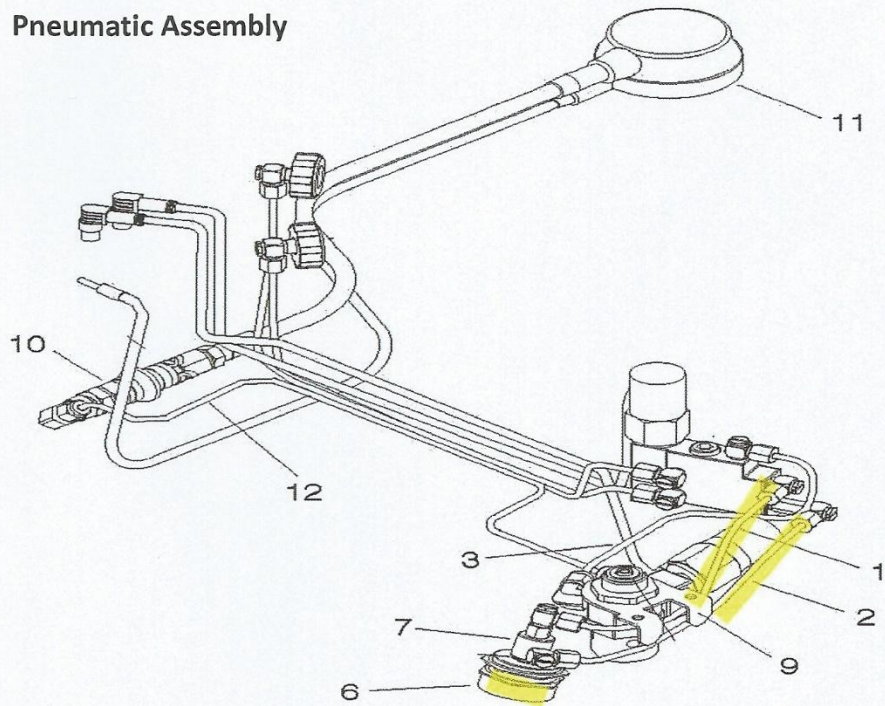

Identification of Parts

- 21. Item # 16 of the upper housing assembly drawing
foam spacer oxygen cylinder hold-down strap bottle holder strap

- 22. Item # 2 of the upper housing drawing
Coil spring Stainless coil spring Diaphragm springs

- 23. Item #12 of the upper housing drawing
foam pad vibration pad latch foam pad

- 24. Item # 18 of the upper housing drawing
Hold down strap hold down grip carrying handle

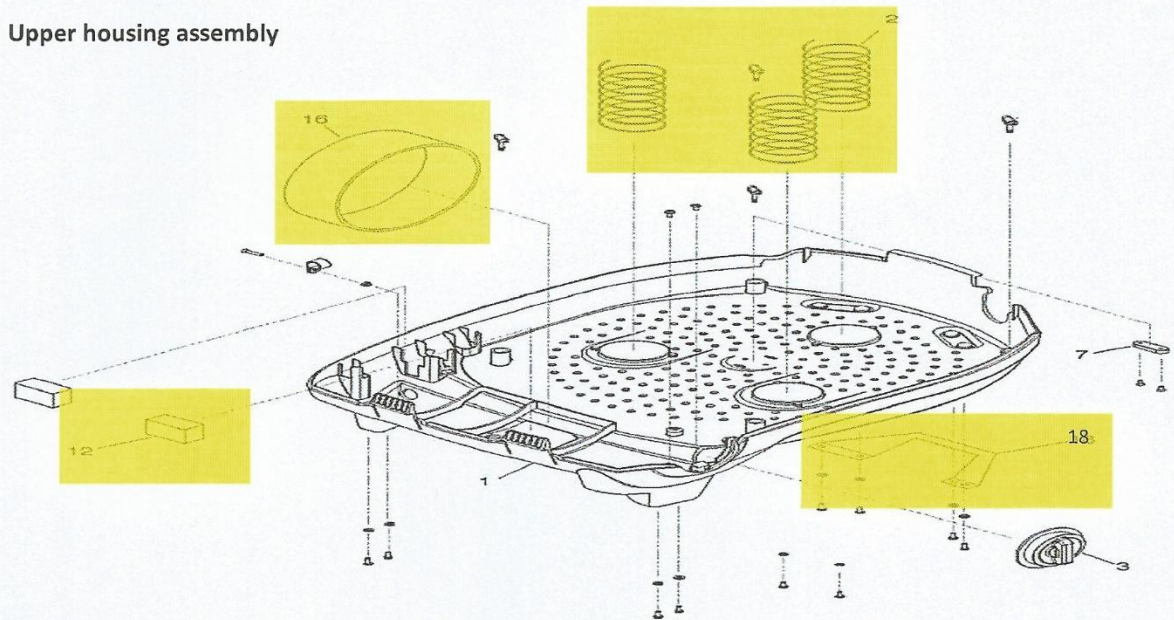

18. Never pry an O-ring from its glands with a _____. Remove O-rings by hand or with the pick tool provided in the service kit.

wrench

screwdriver

pry-bar

19. Cristo-Lube and Dow-111 are the only _____ approved for use in the apparatus.

lubricants

chemicals

pastes

20. The Alarm module will require _____ if any damage to the housing is discovered.

servicing

attention

replacement

9. Remove the oxygen cylinder making sure the outlet tube _____ remains in place and install the regulator cover.
 gasket o-ring washer
10. C.O.P.D. could limit or _____ the use of the BioPak 240 Revolution.
 prohibit limit prevent
11. The manual(s) are the _____ recommended procedures for maintaining the BioPak 240R.
 maximum minimum specific
12. To _____ mold growth remove the moisture control foam pads after each use.
 limit prevent prohibit
13. Pre-packing the BioPak 240 R with carbon dioxide scrubbers is only permitted when utilizing _____ carbon dioxide scrubber.
 factory refillable Orbsorb
14. Pre-packed carbon dioxide scrubbers may only be stored in the _____ for a maximum period of 1-year.
 containers apparatus boxes
15. Users are not permitted to mix _____ of the Orbsorb within a BioPak.
 versions containers types
16. The oxygen cylinder must be fully charged to above _____ psi to perform a high pressure leak test.
 2600 3000 1500
17. The Cylinder should be _____ regularly for signs of damage to the outer wrapping.
 checked inspected tested

