

Statement 6.30.2021 dk

- You are located in the FAB
- 5 miners are missing
- The BLOWING fan is on
- The maps are up to date. Pillars in this mine are 20' X 20' and entries and crosscuts are 10' wide
- BO is in Xcut between no. 2 and no. 3 entry in the FAB
- Blowing fan is outby no. 1 entry

Written Instructions:

- Explore all accessible areas
- Blowing fan is on and cannot be reversed, stalled or stopped at any time
- Bring all survivors to the FAB
- Cannot carry more than 2 brattice cloths when traveling
- Pump switch at CCA can be turned on and off

Problem Keys

Team Stop 1

Must go up no.1 entryNO2 is above 2ppm

Team stop 6

Fred will yell “help get me out” from barricade.....Have patient wearing a depleted SCSR if possible

Team stop 8

No response from barricade

Team stop 9

Team maps should map body in unsafe rib

Team stop 12

Same “Fred” will yell from inby unsafe roof “Help, Get me out” and team should timber to patient using the 3 timbers at that team stop. The 7 PPM NO2 is irrespirable and will follow team into the barricade. (Unsafe ROOF AND GAS PLACARD are side by side

Team must not move Fred until proper protection has been provided for Fred. If possible have Fred wearing an SCSR that shows depleted

After rescue of Fred, team must pump water before doing vent 1 (See pumping map) Only 40’ of pump cable available on the portable pump, so team will need to pump water roofed to get to water over knee deep area with enough pump cable

Team should airlock water roofed before pumping. (Rule 41, if two sides are blocked, then one airlock must be built.

Captain should finish roof and rib test at diagonal unsafe roof on both sides where water over knee deep was pumped down to knee deep.

Note: have diagonal unsafe roof markings down on field, so team can see the unsafe roof going to the ribs when water over knee pumps down to knee deep

After pumping water, teams can now do vent 1, 2 and 3 to rescue unconscious patient behind barricade (See vent maps)

*Please note that pump should be off before doing any vents

End of problem

6.30.21 dk

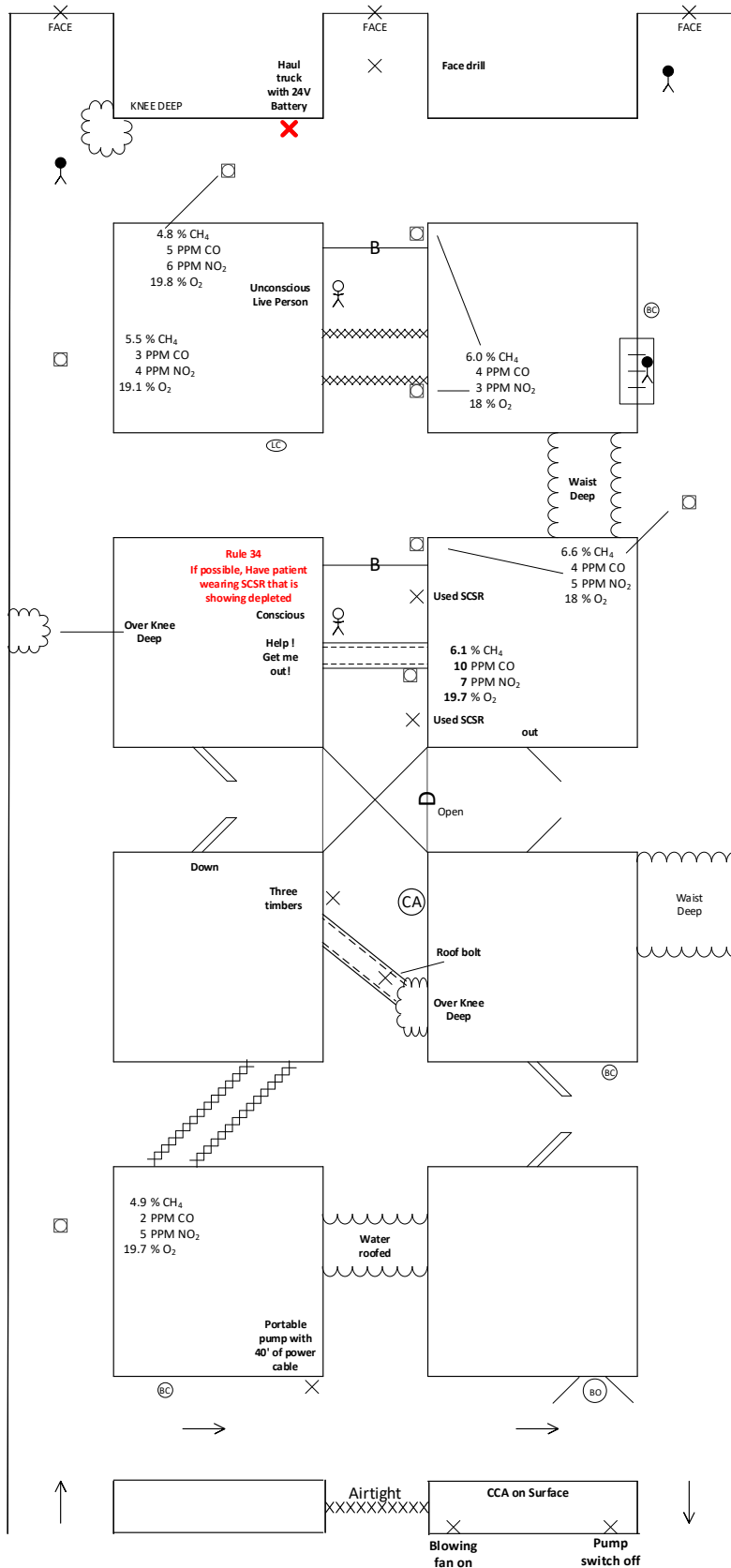

6.30.21 dk

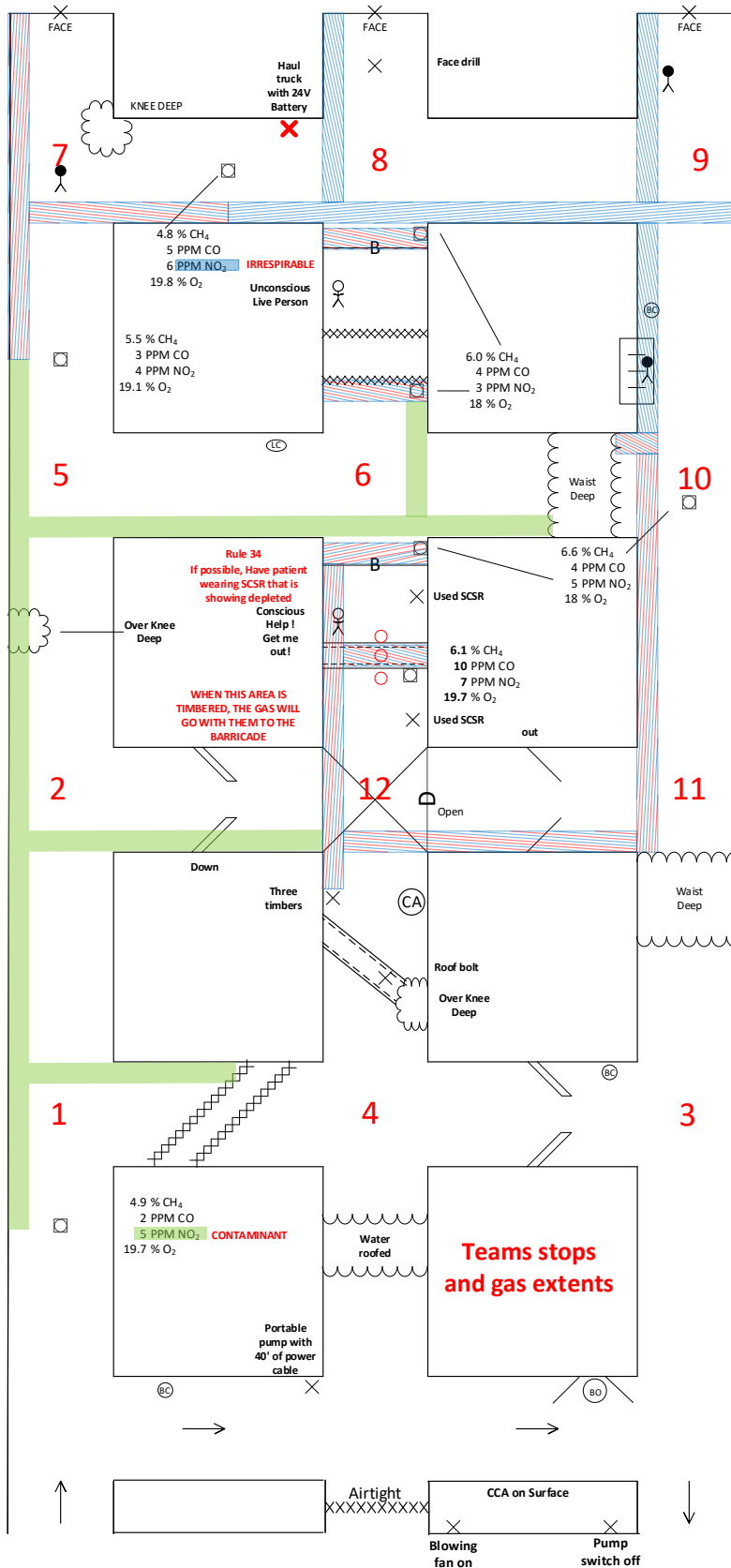

6.30.21 dk

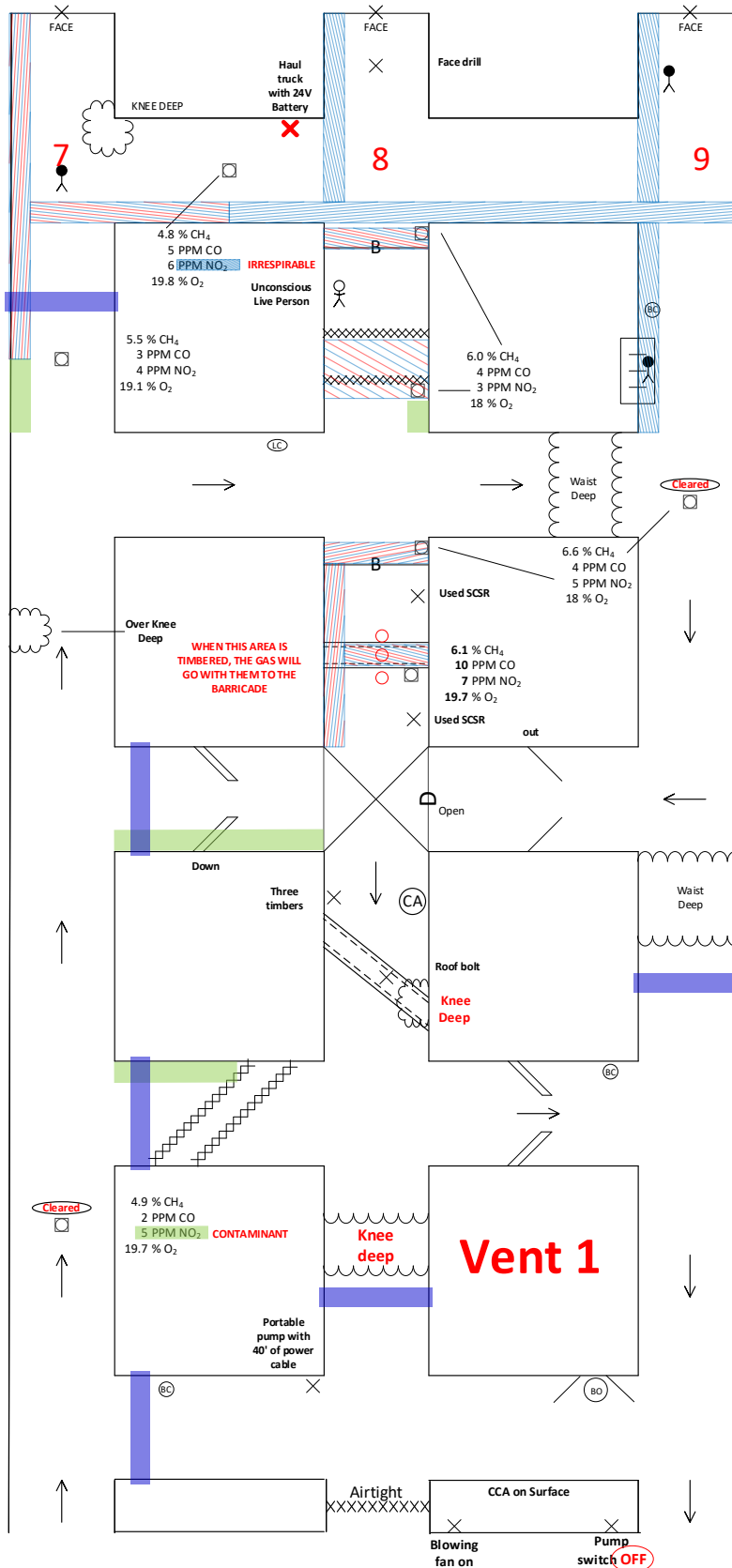

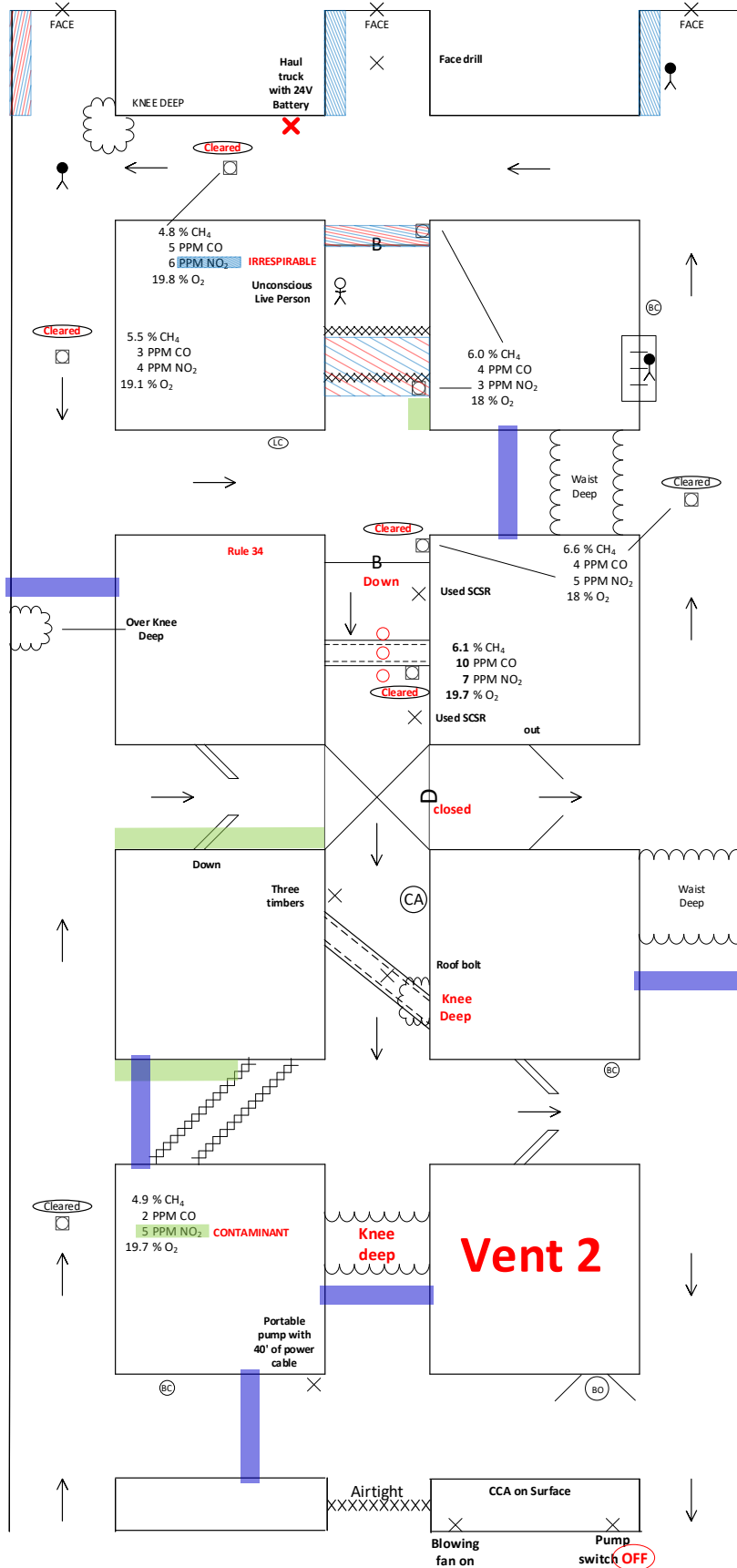

6.30.21 dk

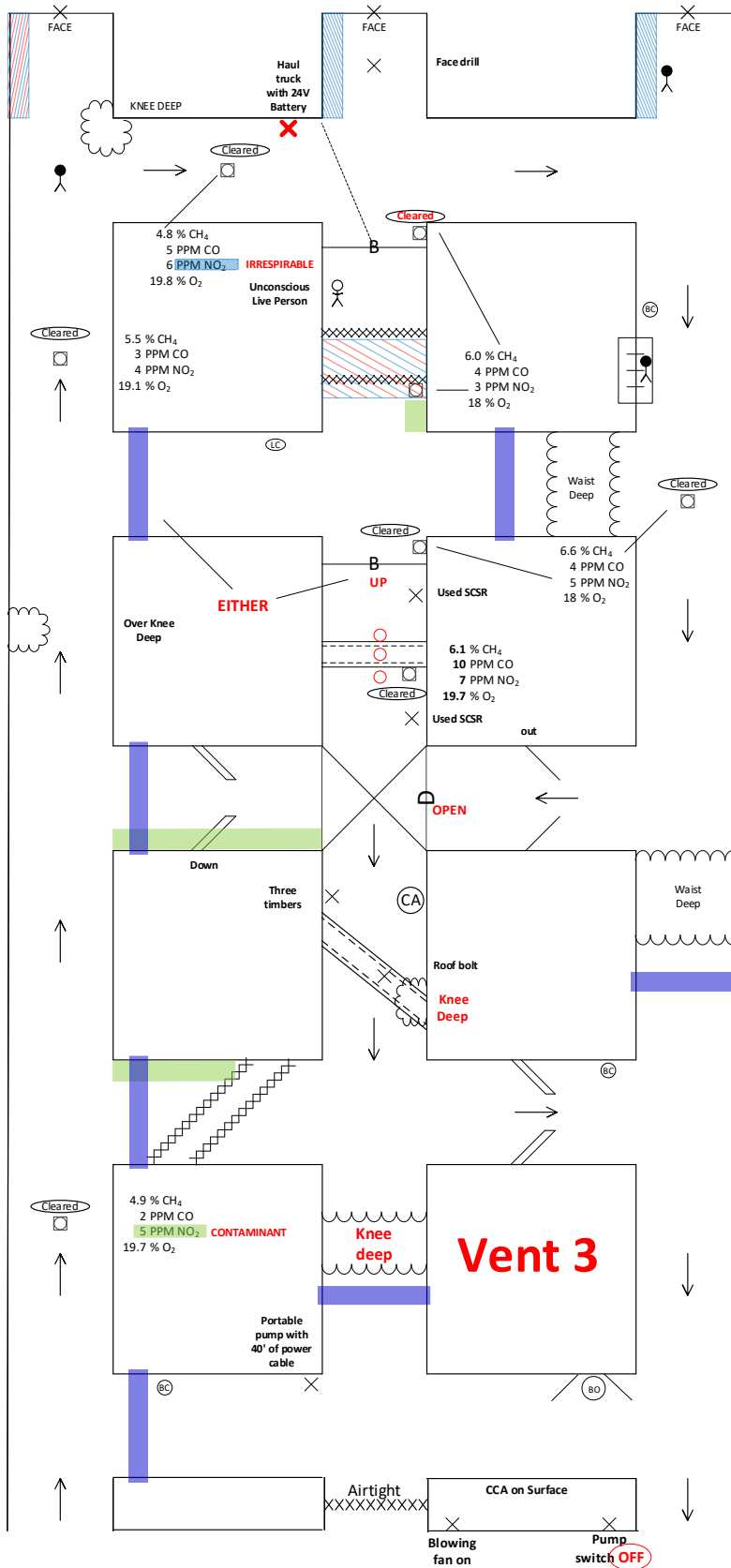

6.30.21 dk

